



19
08.01

SFA

NOTICE D'INSTALLATION • INSTALLATION INSTRUCTIONS • INSTALLATIONSHINWEISE
ISTRUZIONI PER L'INSTALLAZIONE • NOTA DE INSTALACION
INSTALLATIE VOORSCHRIFTEN • INSTALLATIONSANVISNING • INSTALLATIONSVEJLEDNING
INSTALLASJONSANVISNING • INSTRUKCJA INSTALACYJNA
MANUAL DE INSTALAÇÃO • FELSZERELÉSI ÉS KEZELÉSI ÚTMUTATÓ



A lire attentivement et à conserver à titre d'information • The user should retain these instructions for future reference
Bitte aufmerksam durchlesen und aufbewahren • Da leggere attentamente e conservare a titolo d'informazione
A leer detenidamente y a conservar a título informativo • Aandachtig doorlezen en bewaren • Läs igenom anvisningen noga och spara den
Gennemlæs vejledningen nøje og opbevar den • Les anvisningen nøye og oppbevar den til senere bruk • Do uważnego przeczytania i zachowania tytułem informacji.
Ler atentamente e guardar a título de informação • Figyelmesen olvassa el és őrizze meg ezt a felszerelési és kezelési útmutatót!

SANIDOUCHE® / SANISHOWER® 230-240V~
D60-IP44  **50Hz**
250W

F GB D I E NL S DK N PL P H

SANIDOUCHE® SANISHOWER®

Z - 53.3 - 397

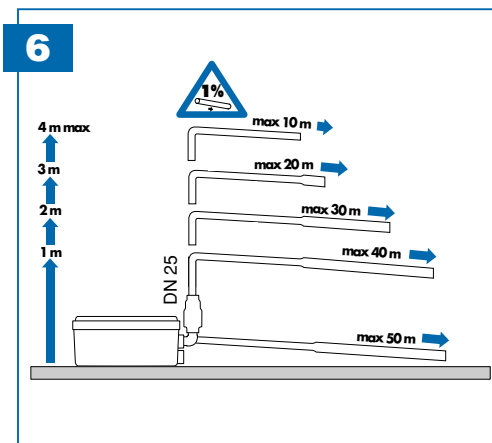
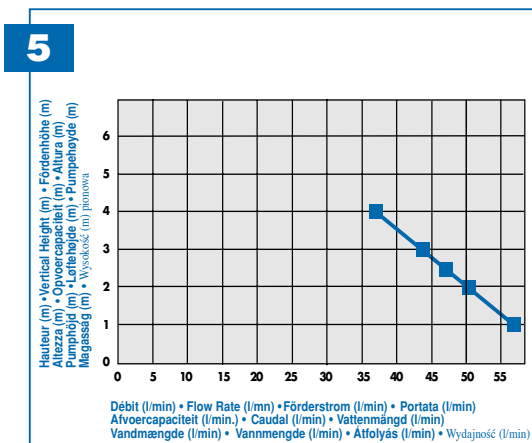
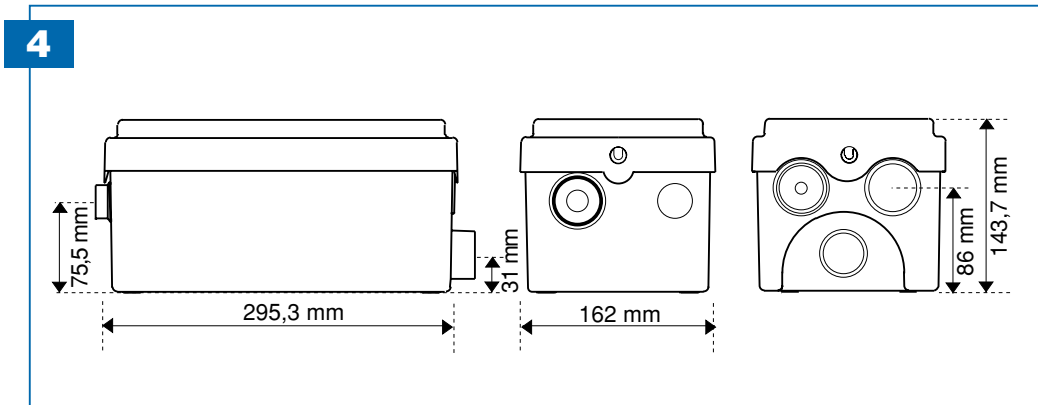
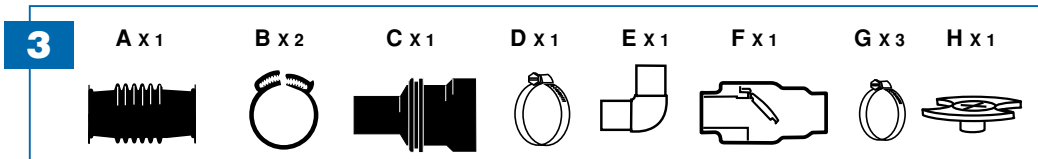
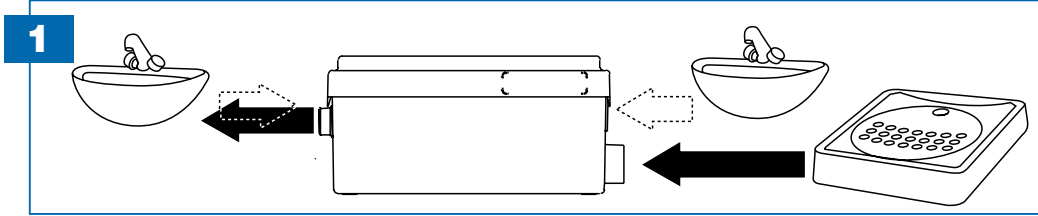

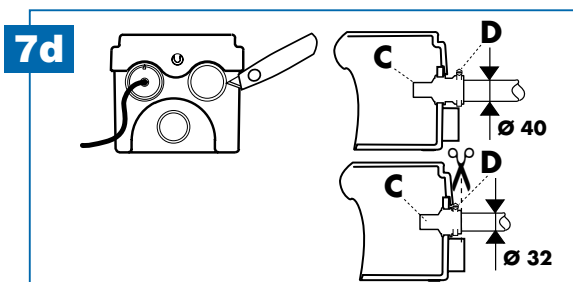
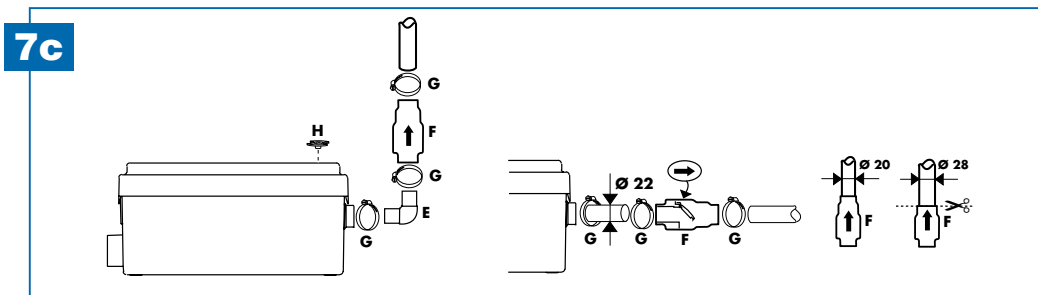
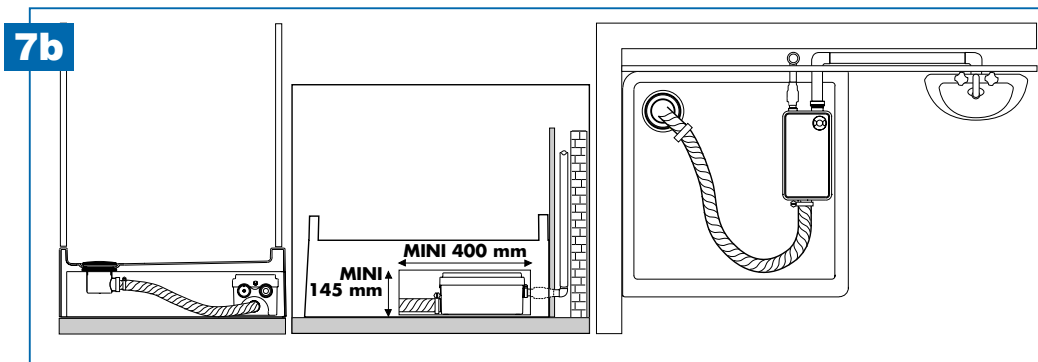
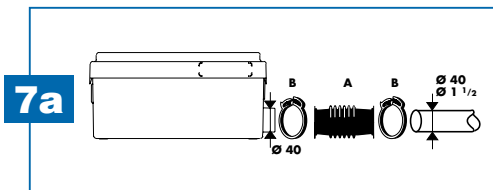
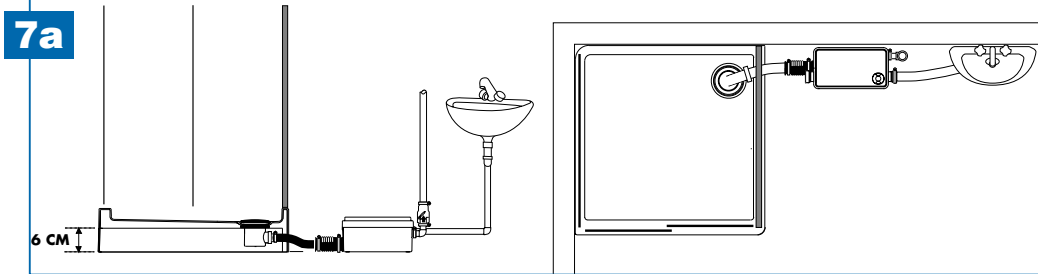



04/98

1 DESCRIPTION
SANISHOWER® is a special domestic pump designed to take the waste from a shower and wash basin. Its compact size and low activation level make it ideal for installation next to or under a shower tray (as long as it is accessible for possible maintenance).
 Installed correctly, it will give consistent, reliable service.

Please note the following warning signs:



Possible danger to personnel



Warning of possible electrical hazard

WARNING: This is a general warning that failure to follow instructions could result in poor functioning of the unit.

2 TECHNICAL DATA

SANISHOWER®	
Application	1 Shower and 1 Washbasin
Vertical Pumping Max	4 m
Horizontal Pumping Max	50 m
Nominal Power Rating	250 W
Medium Water Temperature	35°C
Electric Class	I
Type	D60
Noise Level	40dBA
Net Weight	3,5 KG

3 LIST OF ACCESSORIES INCLUDED:
 Refer to drawing.

4 DIMENSIONS: Refer to drawing.

5 PERFORMANCE CURVE: Refer to graph.

6 VERTICAL/HORIZONTAL PUMPING COMBINATIONS: Refer to drawing.

7 INSTALLATION

2 types of installation are possible with **SANISHOWER®**

- Installation next to the shower tray.
- Installation underneath the shower tray.

Please follow the relevant sections 7a or 7b below.

7a INSTALLATION NEXT TO THE SHOWER TRAY



ELECTRICAL INSTALLATION

The electrical installation should be carried by a qualified person. All wiring must conform to BS7671 1992 - Requirements for electrical installation.

- The **SANISHOWER®** requires 230/240V. AC single phase 50HZ supply (UK specification) and should be connected to an unswitched fixed wire connector fitted with a 5-amp fuse or circuit breaker.
- The **SANISHOWER®** should be installed 60cm. Minimum from the shower tray, or should be separated from it with a fixed panel. It should not be possible to splash the **SANISHOWER®** in normal use.
- The mains lead wiring colour code is as follows:

BROWN	= LIVE
BLUE	= NEUTRAL
GREEN/YELLOW	= EARTH

CONNECTION OF INLET

Connect the wider end of the flexible connector A to the **SANISHOWER®** side inlet. The other end should be connected to the 40mm waste pipe from the shower tray. Use the plastic "Herbie" clips B. Tighten clip B with a pair of pliers.

WARNING: When connecting a shower please make sure that the underside of the shower tray is at least 6 cm above floor level.

7b INSTALLATION UNDERNEATH THE SHOWER TRAY



INSTALLATION

This type of installation should only be carried out by a qualified person. The shower tray must be raised so as to allow 145mm to accommodate the **SANISHOWER®**.

WARNING: It is important that an access panel of minimum length 400mm and height 145mm is provided for possible maintenance of the unit.

A screwdriver or other tool should be required to open the access panel.



ELECTRICAL INSTALLATION

The electrical installation should be carried by a qualified person. All wiring must conform to BS7671 1992 - Requirements for electrical installation.

- The **SANISHOWER®** requires 230/240V. AC single phase 50HZ supply (UK specification) and should be connected to an unswitched fixed wire connector fitted with a 5-amp fuse or circuit breaker.



02/98a

- The **SANISHOWER®** should be installed 60cm. Minimum from the shower tray, or should be separated from it with a fixed panel. It should not be possible to splash the **SANISHOWER®** in normal use.
- The mains lead wiring colour code is as follows:

BROWN	=	LIVE
BLUE	=	NEUTRAL
GREEN/YELLOW	=	EARTH

CONNECTION OF SHOWER TRAY TO THE SIDE INLET

When siting the unit underneath the shower tray, we recommend that you use a flexible pipe for the shower waste (e.g. Jollyflex). This is so that the unit can be moved from under the tray for possible maintenance, without undoing any of the original waste connections.

The waste pipe should be connected to the **SANISHOWER®**, using the flexible 40mm rubber connector A.

7c INSTALLATION OF THE DISCHARGE PIPE

- Connect elbow E to the discharge spigot, using clip G.
- Connect the non-return valve F to the other end of the elbow E, using clip G.
- Where the non-return valve is installed horizontally use a length of rigid 22mm pipe to join it to the **SANISHOWER®** discharge outlet, using 2 clips G (in this case do not use elbow E).
If the non-return valve is installed horizontally, the arrow should show along the top.
- For the discharge, use 22mm Copper, or CPVC pipework.

WARNING

- Please refer to figure 6 to determine vertical/ horizontal pumping combinations.
- If pumping vertically, always put the vertical run before the horizontal run.
- All horizontal runs require a fall of 1:100.
- If the discharge run is longer than 10m, increase the pipe size to 32mm from that point onwards.
- Install the non-return valve so that the arrow points in the direction of flow.
- If the non-return valve is installed horizontally, the arrow should **show along the top**.

7d CONNECTION TO THE OPTIONAL INLET

- Use a cutter (e.g. Stanley knife) to remove the cap from the optional inlet (see figure 7d). Make sure the hole is not cut at an angle, and that the edges are deburred.

WARNING:

Make sure that this operation is carried out

precisely, otherwise the joint will not be watertight.

- The rubber connector C can be used for 40mm or 32mm waste pipe. If fitting 32mm waste, cut off the end of connector C (see figure 7d). Push the neck of connector C into the inlet hole. It is a grip fit, which is why the hole must be cut accurately). Secure the waste pipe to C with clip D.

8 COMMISSIONING THE UNIT

First recheck all the electrical and water connections.

Fill the handbasin with water, release the plug and check for leaks at connection C. Turn on the shower and allow it to run for several minutes at the maximum flow rate and temperature required for normal use. Ensure there are no leaks.

WARNING: Do not close access panel until this has been checked

9 CARE AND USE OF YOUR SANISHOWER®

The **SANISHOWER®** has been designed to take the waste from a shower and washbasin in a domestic situation. It is not designed for commercial use.

WARNING:

- If the **SANISHOWER®** runs with extremely hot water for a prolonged period, the thermal cut out will engage. The unit will stop pumping, and after cooling for approximately 1 hour, will resume normal operation.
- Do not use **SANISHOWER®** with power showers with a flow rate of more than 15 l/m.
- The shower connected to the **SANISHOWER®** should be fitted with a trap that conforms to normal regulations.

10 CLEANING OF SANISHOWER®

The **SANISHOWER®** has been designed to accept normal household sanitary cleansing products. Do not dispose of solvents, acids caustic or other strong chemicals via the **SANISHOWER®**.

11 MAINTENANCE

 **Disconnect electricity supply before any service work.**

The **SANISHOWER®** does not require any particular maintenance. Any work carried out on the **SANISHOWER®** should be by a registered Saniflo service engineer.

12 GUARANTEE

The **SANISHOWER®** is guaranteed for 2 years, provided it is installed and used correctly, according to these instructions.

